

HEX NUT

316 STAINLESS STEEL



Import



Precision
Machined

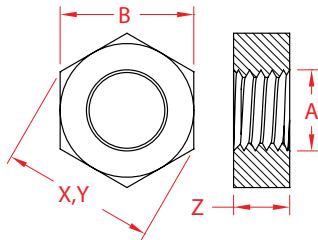

ITEM	A (size)	B (wrench)	THREAD	X (height)	Y (length)	Z (width)	WT (lb)	PACKAGING TYPE	EACH (qty)	INNER (qty)	CARTON (qty)	UPC
LEFT HAND, UNC												
S0302-0005	3/16"	0.31" 5/16"	10-24	0.35"	0.35"	0.16"	0.25/100	POLYBAG	1	100	10000	791506038252
S0302-0007	1/4"	0.43" 7/16"	1/4"-20	0.49"	0.49"	0.22"	0.42/100	POLYBAG	1	100	5000	791506038269
S0302-0008	5/16"	0.49" 1/2"	5/16"-18	0.55"	0.55"	0.26"	0.82/100	POLYBAG	1	100	4000	791506038276
S0302-0010	3/8"	0.54" 9/16"	3/8"-16	0.63"	0.63"	0.33"	1.5/100	POLYBAG	1	100	3000	791506038283
S0302-0013	1/2"	0.75" 3/4"	1/2"-13	0.85"	0.85"	0.44"	3.5/100	POLYBAG	1	100	1000	791506038290
S0302-0016	5/8"	0.93" 15/16"	5/8"-11	1.06"	1.06"	0.55"	7.0/100	POLYBAG	1	100	600	791506038306
S0302-0020	3/4"	1.13" 1-1/8"	3/4"-10	1.25"	1.25"	0.66"	13.0/100	POLYBAG	1	50	400	791506038313
S0302-0025	1"	1.51" 1-1/2"	1"-8	1.67"	1.67"	0.84"	31.0/100	POLYBAG	1	10	150	791506038320

NOTE:
ALL DIMENSIONS ARE NOMINAL (+/- 3%) AND ARE SUBJECT TO CHANGE WITHOUT NOTICE.